

Mouse / Pointing Device

Quick Assessment

Windows

[Windows 10 Settings](#)

[Make your PC easier to use](#)

MacOS

[Change Settings](#)

[Accessibility Support](#)

Chromebooks

[Chromebook accessibility](#)

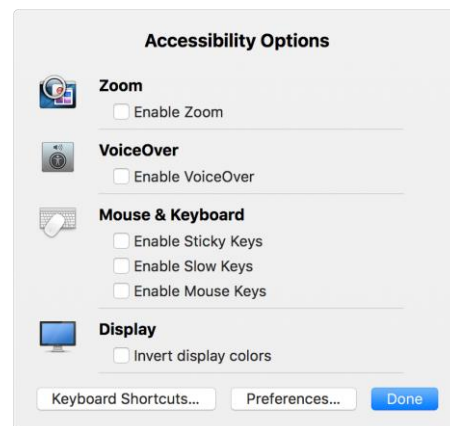
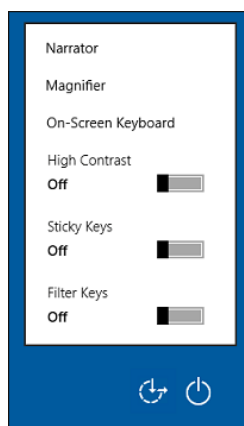

Observation..	Consider..
The user can move the mouse pointer but...	
<i>...not very accurately</i>	practice! seating and positioning vision slowing down the mouse speed AMAneo Assistive Mouse Adapter to filter out tremor mouse alternatives e.g. trackball, joystick etc programs with larger targets increasing the size of text, menus and buttons with the Settings or WinTools' System Font Size Changer .
<i>...has difficulty seeing the pointer</i>	increase the Pointer Size in the Settings
<i>...hits mouse buttons by mistake</i>	single button mouse switches instead of buttons a trackball or other pointing device
<i>...can't hold down the button to 'drag'</i>	a mouse or pointing device with a separate drag button, or programmable buttons a three-button mouse with programmable buttons ClickLock in the mouse settings MouseKeys - press "0" on the numperpad to lock and "." to release the mouse button software Drag program such as Dwell Clicker or Point N Click
<i>...can't double-click (fast enough)</i>	slow down the double-click speed in the Mouse Settings a mouse or other pointing device with a separate double-click button a three-button mouse with programmable buttons MouseKeys - press "+" on the numperpad to double click.
<i>...can't hit the mouse button(s)</i>	a trackball, joystick or other device, with bigger or different buttons

	switches instead of the button(s), plugged into a trackball, joystick or other device
	MouseKeys - press "5" on the numperpad to left-click
	mouse click or 'dwell select' software such as Dwell Clicker or Point N Click
<i>...suffers pain when moving the mouse</i>	ergonomic mouse or other pointing device such as trackball, touch pad, graphics tablet, head operated mouse or eye gaze
	seating and positioning
	wrist rests
	speech recognition
<i>...can't move the pointer across the across the whole screen</i>	seating and positioning
	arm supports
	increase mouse speed/sensitivity
	ergonomic mouse or other pointing device such as trackball or touch pad
The user cannot hold or move the mouse and...	
<i>....has reasonable finger, thumb or wrist control</i>	trackball
<i>....has good forearm control</i>	joystick
<i>...has good finger control</i>	MouseKeys - use the numperpad to control the mouse
	separate touch pad
	thumb-operated trackball
	tablet device or touch screen
<i>... has good chin control</i>	chin joystick
<i>...has good mouth control</i>	mouth joystick
	MouseKeys - use a mouthstick on the numperpad
<i>...has good head control</i>	MouseKeys - use a head or chin pointer on the numperpad
	head-operated mouse
	chin joystick
	switches (see below)
<i>...has good eye control</i>	eye-gaze mouse control
<i>...has clear speech</i>	speech recognition
<i>...does not understand that the mouse controls the pointer</i>	touch screen
<i>...can use a standard or alternative keyboard</i>	MouseKeys - use the numperpad to control the mouse
	keyboard short-cuts
<i>...can operate several switches</i>	direct switch control with a switch interface such as Hitch
<i>...can operate one or two switches</i>	on-screen scanning or rotating pointer switch control with e.g. Grid 3
	hardware switch scanner e.g. Track-IT!